

8

7

6

5

4

3

2

1

E

D

C

B

A

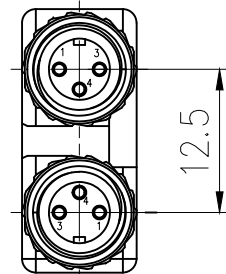
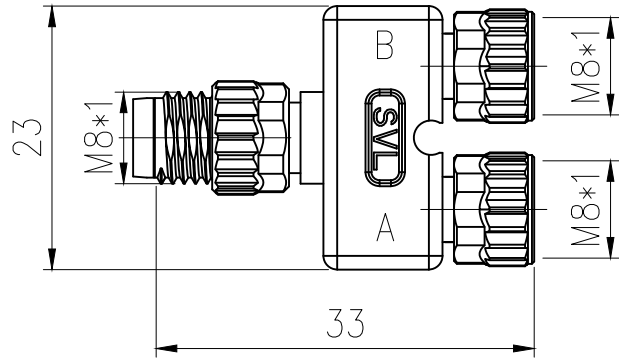
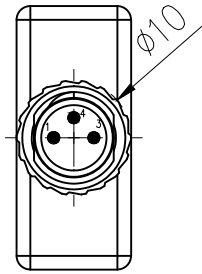

材料和技术参数(Material&Technical data):

金属件(Metallic parts): 锌合金(Zinc alloy)

接触件(Contact): 铜镀金(Copper plated)

密封件材质(Seal material): NBR

插芯材质(Core insert material): TPU

包胶体(Encapsulated colloid): TPU Black

额定电压(Rated voltage): 50V AC/60V DC

额定脉冲电压(Rated pulse voltage): 1500V

额定电流(Rated current)(40°C): max.4A

温度范围(Temperature range): -25...+85°C

防护等级(Protection): IP67(插孔插针配合拧紧)(EN 60529)

When plugged and screwed down

执行标准(Executive standard): IEC 61076-2-104

绝缘电阻(Insulation resistance): ≥100MΩ

接触电阻(Touch resistance): ≤5mΩ

可插拔次数(Number of pluggable times): ≥ 100

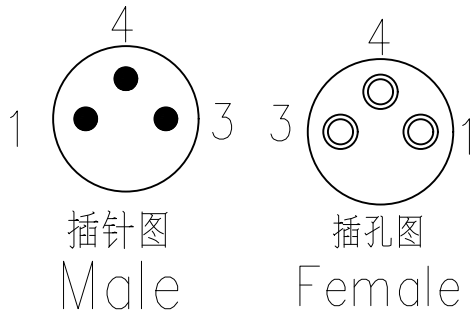

接线图:
Circuit Diagram:

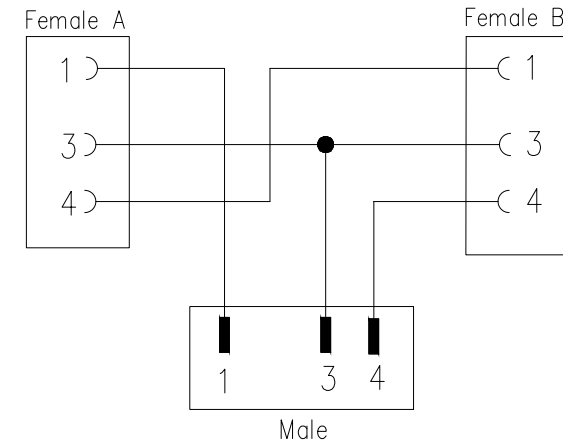

SIGN	REVISION	NAME	DATE
DIMENSION CLASSIFICATION			

MATERIAL : SEE TABLE	
FINISH : SEE TABLE	
DRAWN BY:	CHK'D BY:
APP'D BY :	SCALE : 1 : 1
SHEET 1 OF 1	UNIT : mm
DATE :	DAN :

兴威联电气 — SVLEC —	
TITLE: Y型连接器M8-3P公插转2M8-3P母插	
DWG. NO.: 988621	REV AX

8

7

6

5

4

3

2

SVL\P\M8